



小型钮子开关 Miniature Toggle Switch MTS Series



RoHS

型号说明 Ordering Information

MTS-102-A1

端子种类 Terminal options
手柄种类 Handle options
电路特性 Circuitry trait
刀数 Poles
小型钮子开关 Miniature Toggle Switch

技术特性 Specification

- 1.规格 Rating:6A 125VAC;3A 250VAC
- 2.接触电阻 Contact Resistance:20mΩ max
- 3.绝缘电阻 Insulation Resistance:500VDC 1000MΩ min
- 4.耐电压 Dielectric Strength:1500VAC ,1Minute
- 5.操作温度 Operating Temperature:-25℃ ~ +85℃
- 6.电气寿命 Electrical Life:10,000 Cycles
基座颜色 Base color

电路特性 Circuitry trait

型号 Model No	电路特性 Circuitry trait			类型 Type	端子数 Terminals
MTS-101	ON	—	OFF	SPST	2P
MTS-102	ON	—	ON	SPDT	3P
MTS-112	ON	—	(ON)	SPDT	3P
MTS-103	ON	OFF	ON	SPDT	3P
MTS-113	ON	OFF	(ON)	SPDT	3P
MTS-123	(ON)	OFF	(ON)	SPDT	3P





型号 Model No	电路特性 Circuitry trait			类型 Type	端子数 Terminals
MTS-201	ON	—	OFF	DPST	4P
MTS-202	ON	—	ON	DPDT	6P
MTS-212	ON	—	(ON)	DPDT	6P
MTS-203	ON	OFF	ON	DPDT	6P
MTS-213	ON	OFF	(ON)	DPDT	6P
MTS-223	(ON)	OFF	(ON)	DPDT	6P

()回弹指示 Indicates Momentary

手柄种类 Handle options

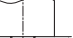
标准 Standard (A)	长型 Long (B)	短型 Short (C)	带柄套 With handle cap (D)	大型 Grand (G)	特大型 Large handle (L)	塑料扁柄 Plastic Flat (E)	金属扁柄 Metal Flat (F)	长金属扁柄 Long Metal Flat (FL)
				1/4-40NS	M12X0.75	1/4-40NS		

端子种类 Terminal options

Solder terminal (1)	PC terminal (2)	PC-H terminal (3)	PC-V terminal (4)	Long Solder terminal (5)	铭牌 Nameplate												
																	
					<table><tr><td>(1)</td><td>ON</td><td>—</td><td>OFF</td></tr><tr><td>(2)</td><td>ON</td><td>—</td><td>ON</td></tr><tr><td>(3)</td><td>ON</td><td>OFF</td><td>ON</td></tr></table>	(1)	ON	—	OFF	(2)	ON	—	ON	(3)	ON	OFF	ON
(1)	ON	—	OFF														
(2)	ON	—	ON														
(3)	ON	OFF	ON														

材料 Material	基座颜色 Base color	
塑料 PBT	蓝 Blue	
电木 Bakelite	红 Red	黑 Black

防水帽 Water proof cap

WPC-04	
WPC-05	

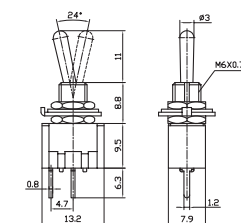
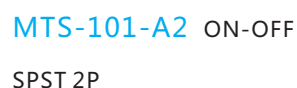
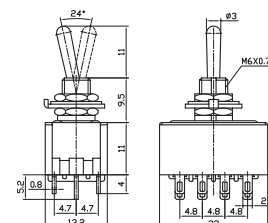
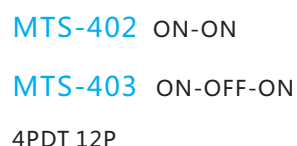
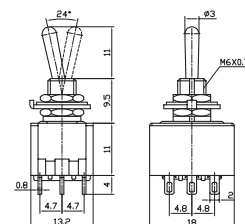
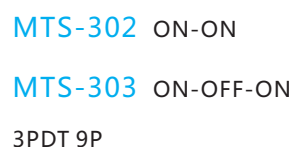
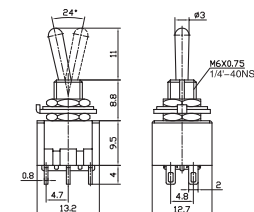
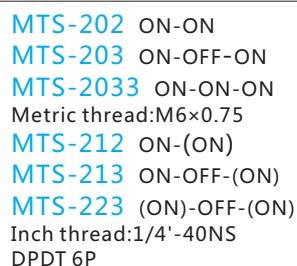
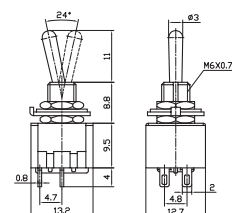
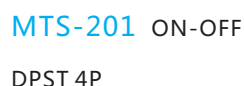
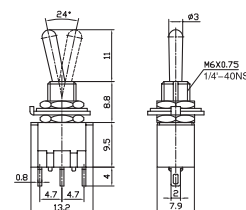
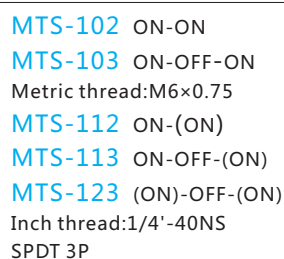
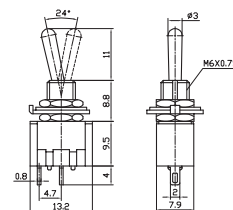
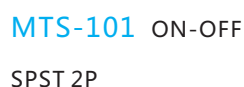

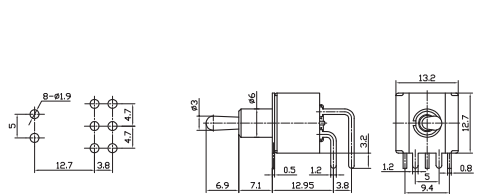
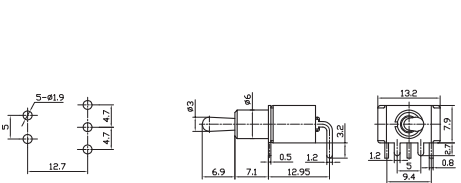
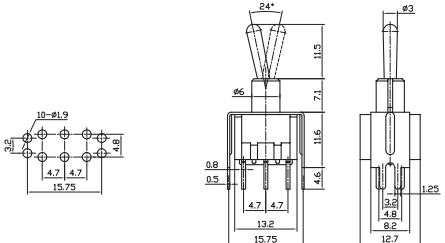
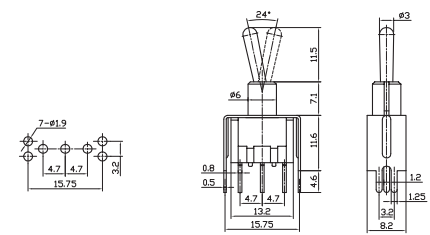
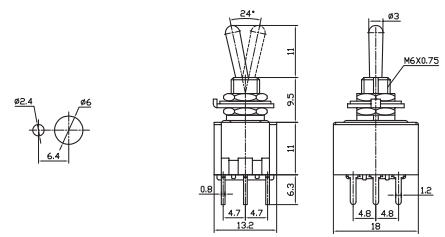
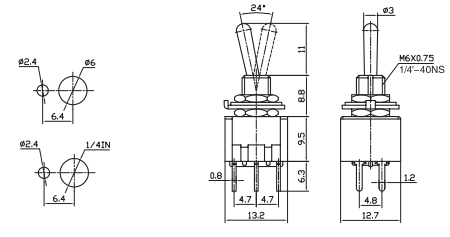
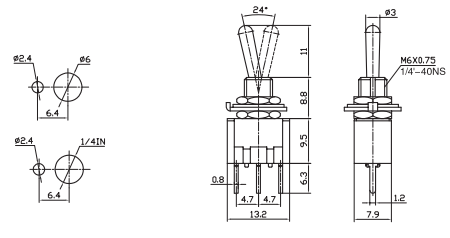



小型钮子开关 Miniature Toggle Switch MTS Series

	<p> MTS-102-C4 ON-ON MTS-112-C4 ON-(ON) MTS-103-C4 ON-OFF-ON MTS-113-C4 ON-OFF-(ON) MTS-123-C4 (ON)-OFF-(ON) SPDT 3P </p>	
	<p> MTS-202-C4 ON-ON MTS-212-C4 ON-(ON) MTS-203-C4 ON-OFF-ON MTS-213-C4 ON-OFF-(ON) MTS-223-C4 (ON)-OFF-(ON) DPDT 6P </p>	
	<p> MTS-101-E1 ON-OFF SPST 2P (PLASTIC FLAT LEVER) </p>	
	<p> MTS-102-E1 ON-ON MTS-112-E1 ON-(ON) MTS-103-E1 ON-OFF-ON MTS-113-E1 ON-OFF-(ON) MTS-123-E1 (ON)-OFF-(ON) SPDT 3P (PLASTIC FLAT LEVER) </p>	
	<p> MTS-202-E1 ON-ON MTS-212-E1 ON-(ON) MTS-203-E1 ON-OFF-ON MTS-213-E1 ON-OFF-(ON) MTS-223-E1 (ON)-OFF-(ON) DPDT 6P (PLASTIC FLAT LEVER) </p>	
	<p> MTS-101-F1 ON-OFF SPST 2P (METAL FLAT LEVER) </p>	
	<p> MTS-102-F1 ON-ON MTS-112-F1 ON-(ON) MTS-103-F1 ON-OFF-ON MTS-113-F1 ON-OFF-(ON) MTS-123-F1 (ON)-OFF-(ON) SPDT 3P (METAL FLAT LEVER) </p>	



小型钮子开关 Miniature Toggle Switch MTS Series

	<p> MTS-202-F1 ON-ON MTS-212-F1 ON-(ON) MTS-203-F1 ON-OFF-ON MTS-213-F1 ON-OFF-(ON) MTS-223-F1 (ON)-OFF-(ON) DPDT 6P (METAL FLAT LEVER) </p>	
	<p> KNX-1-D1 ON-ON KNX-103-D1 ON-OFF-ON SPDT 3P </p>	
	<p> KNX-2-D1 ON-ON KNX-203-D1 ON-OFF-ON DPDT 6P </p>	
	<p> STM-101 ON-OFF SPST 2P </p>	
	<p> STM-102 ON-ON STM-103 ON-OFF-ON SPDT 3P </p>	
	<p> STM-202 ON-ON STM-203 ON-OFF-ON DPDT 6P </p>	
	<p> STM-2033 ON-ON-ON DPDT 6P </p>	



小型钮子开关 Miniature Toggle Switch MTS Series

	<p>MTS-102-A1-2 ON-ON MTS-112-A1-2 (ON)-ON SPDT 3P</p>	
	<p>MTS-102-A1-2L ON-ON MTS-112-A1-2L (ON)-ON SPDT 3P</p>	
	<p>MTS-102-F1-2 ON-ON MTS-112-F1-2 (ON)-ON SPDT 3P</p>	
	<p>MTS-102-F1-2L ON-ON MTS-112-F1-2L (ON)-ON SPDT 3P</p>	
	<p>MTS-102-G1 ON-ON MTS-112-G1 (ON)-ON SPDT 3P</p>	
	<p>MTS-102-L1 ON-ON MTS-103-L1 ON-OFF-ON SPDT 3P</p>	
	<p>MTS-101-DL ON-OFF SPST 2P MTS-102-DL ON-ON MTS-103-DL ON-OFF-ON SPDT 3P</p>	